



Finishes You've Never Seen Before®

WESTERN REVEAL® FLUSH REVEAL PANEL - 12" FACE SIZE

For Metal Wall Panels, Fascia, Soffit, and Ceiling Panels

Available Materials: Aluminum, Copper, Corten/A606-4, Steel

Available Finishes: Bare Steel, Galvalume®/Zincalume®, Galvanized, PVDF, SMP Painted



View Product

SPECIFICATIONS:

Profile Type:	Western Reveal®
Face Size:	12"
Available Reveals:	<ul style="list-style-type: none"> • NR - No Reveal • 1.0 - 1" Reveal • 2.0 - 2" Reveal • 3.0 - 3" Reveal
Available Gauges:	24, 22
Fastening Type:	Concealed
Rib Height:	1.5"
Panel Length:	1' to 35' max
Substrate:	AZ 50 Minimum (Galvalume®/Zincalume®)
Finish:	Cool Tech® 500 – PVDF
Warranty:	40 year limited*
Stiffening Ribs or Pencil Ribs:	Available Upon Request
Single or Double Vent Strips:	Available Upon Request
Installation:	Installed Over A Solid Substrate (Vertical or Horizontal)

TESTING AND APPROVALS:

- Florida Building Code - Residential (FBC)
- ASTM E330 – Uniform Load Structural Test (wall)
- AASTM A653 – G90 Galvanized
- ASTM A792 – Zincalume/Galvalume AZ-50/55

For the complete list, please contact your sales representative

APPLIES TO THE FOLLOWING COLORS/FINISHES:

- | | | |
|-------------------|------------------|-------------------|
| • Almond | • Dark Bronze | • Regal Red |
| • Ash Gray | • Desert Tan | • Regal White |
| • Bone White | • Dolphin Gray | • Royal Blue |
| • Burnished Slate | • Dove Gray | • Sandstone |
| • Champagne† | • Gun Metal Gray | • Silver Metallic |
| • Charcoal Gray | • Mansard Brown | • Slate Blue |
| • Classic Green | • Matte Black | • Slate Gray |
| • Colonial Red | • Medium Bronze | • Terra Cotta |
| • Copper Penny† | • Regal Blue | • Zinc Metallic |

*Limited warranty. Please review prior to purchase.

† This material is batch sensitive and directional.
Do not mix batches or coil lots.

PROFILE:

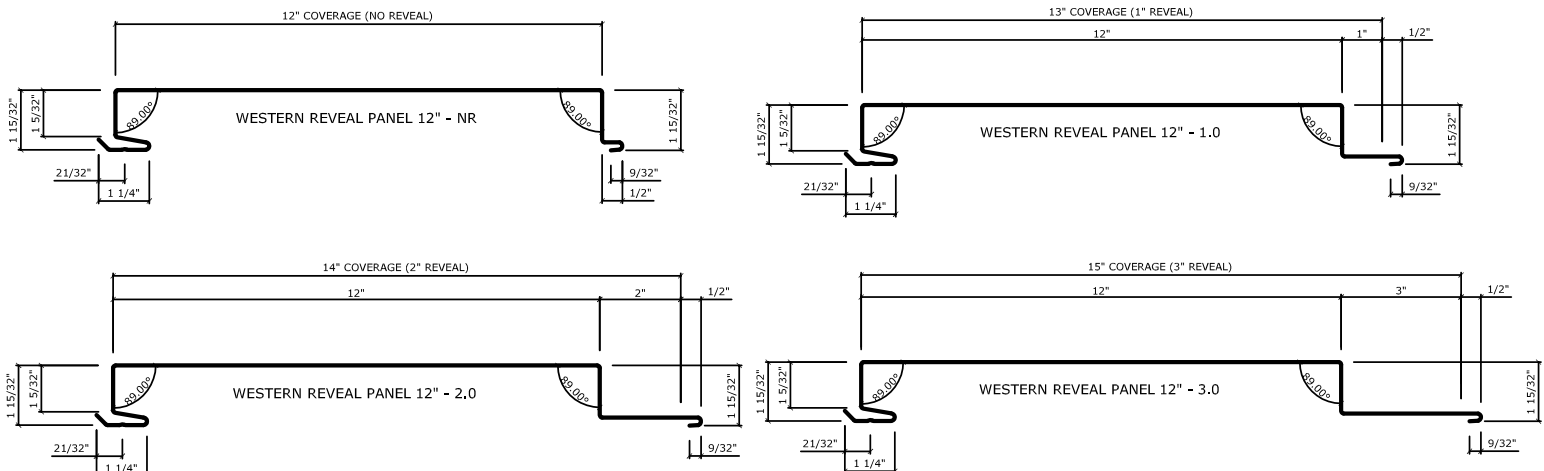

Colors represented on this profile sheet may not match actual material. All colors should be verified using an actual metal color sample.

4131-22 Rev. 01.14.25

Phoenix: ☎ (602) 495-0048 ✉ sales@westernstatesmetalroofing.com | Washington: ☎ (509) 418-2833 ✉ washington-wsmr@westernstatesmetalroofing.com

Tucson: ☎ (520) 574-4247 ✉ tucsonsales@westernstatesmetalroofing.com | Texas: ☎ (972) 843-4343 ✉ texas-sales@westernstatesmetalroofing.com



Finishes You've Never Seen Before®

WESTERN REVEAL® FLUSH REVEAL PANEL - 14" FACE SIZE

For Metal Wall Panels, Fascia, Soffit, and Ceiling Panels

Available Materials: Aluminum, Copper, Corten/A606-4, Steel

Available Finishes: Bare Steel, Galvalume®/Zincalume®, Galvanized, PVDF, SMP Painted



View Product

SPECIFICATIONS:

Profile Type:	Western Reveal®
Face Size:	14"
Available Reveals:	<ul style="list-style-type: none"> • NR - No Reveal • 1.0 - 1" Reveal • 2.0 - 2" Reveal • 3.0 - 3" Reveal
Available Gauges:	24, 22
Fastening Type:	Concealed
Rib Height:	1.5"
Panel Length:	1' to 35' max
Substrate:	AZ 50 Minimum (Galvalume®/Zincalume®)
Finish:	Cool Tech® 500 – PVDF
Warranty:	40 year limited*
Stiffening Ribs or Pencil Ribs:	Available Upon Request
Single or Double Vent Strips:	Available Upon Request
Installation:	Installed Over A Solid Substrate (Vertical or Horizontal)

*Limited warranty. Please review prior to purchase.

TESTING AND APPROVALS:

- Florida Building Code - Residential (FBC)
- ASTM E330 – Uniform Load Structural Test (wall)
- AASTM A653 – G90 Galvanized
- ASTM A792 – Zincalume/Galvalume AZ-50/55

For the complete list, please contact your sales representative

APPLIES TO THE FOLLOWING COLORS/FINISHES:

- | | | |
|-------------------|------------------|-------------------|
| • Almond | • Dark Bronze | • Regal Red |
| • Ash Gray | • Desert Tan | • Regal White |
| • Bone White | • Dolphin Gray | • Royal Blue |
| • Burnished Slate | • Dove Gray | • Sandstone |
| • Champagne† | • Gun Metal Gray | • Silver Metallic |
| • Charcoal Gray | • Mansard Brown | • Slate Blue |
| • Classic Green | • Matte Black | • Slate Gray |
| • Colonial Red | • Medium Bronze | • Terra Cotta |
| • Copper Penny† | • Regal Blue | • Zinc Metallic |

† This material is batch sensitive and directional.
Do not mix batches or coil lots.

PROFILE:

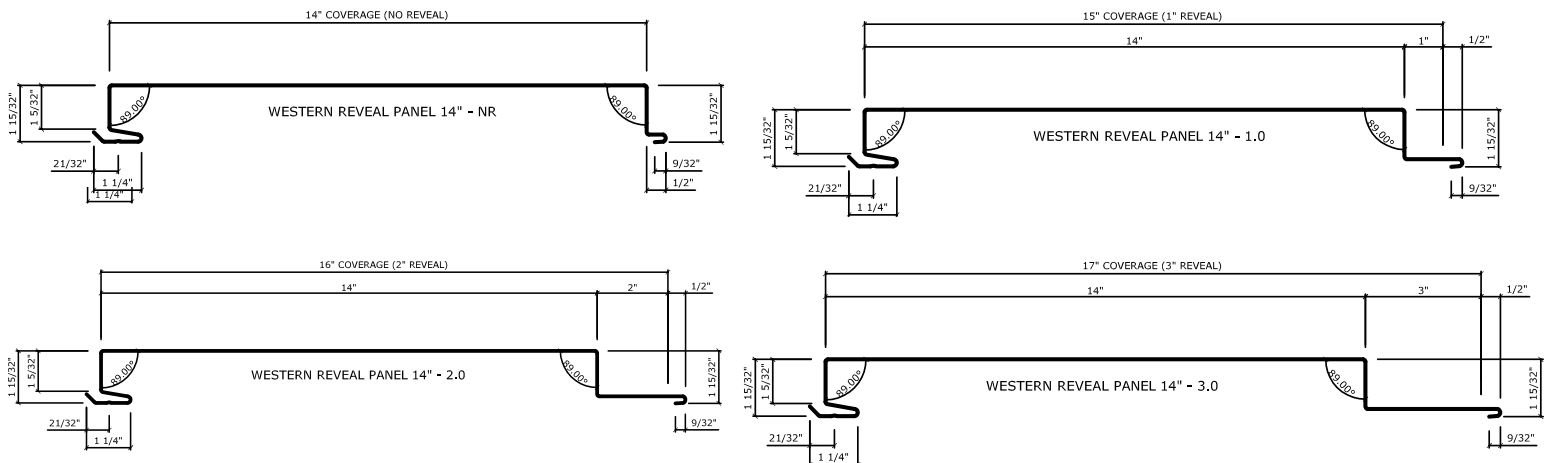

Colors represented on this profile sheet may not match actual material. All colors should be verified using an actual metal color sample.

4131-22 Rev. 01.14.25

Phoenix: ☎ (602) 495-0048 ✉ sales@westernstatesmetalroofing.com | Washington: ☎ (509) 418-2833 ✉ washington-wsmr@westernstatesmetalroofing.com

Tucson: ☎ (520) 574-4247 ✉ tucsonsales@westernstatesmetalroofing.com | Texas: ☎ (972) 843-4343 ✉ texas-sales@westernstatesmetalroofing.com



Finishes You've Never Seen Before®

WESTERN REVEAL® FLUSH REVEAL PANEL - 16" FACE SIZE

For Metal Wall Panels, Fascia, Soffit, and Ceiling Panels

Available Materials: Aluminum, Copper, Corten/A606-4, Steel

Available Finishes: Bare Steel, Galvalume®/Zincalume®, Galvanized, PVDF, SMP Painted



View Product

SPECIFICATIONS:

Profile Type:	Western Reveal®
Face Size:	16"
Available Reveals:	<ul style="list-style-type: none"> • NR - No Reveal • 1.0 - 1" Reveal • 2.0 - 2" Reveal • 3.0 - 3" Reveal
Available Gauges:	24, 22
Fastening Type:	Concealed
Rib Height:	1.5"
Panel Length:	1' to 35' max
Substrate:	AZ 50 Minimum (Galvalume®/Zincalume®)
Finish:	Cool Tech® 500 – PVDF
Warranty:	40 year limited*
Stiffening Ribs or Pencil Ribs:	Available Upon Request
Single or Double Vent Strips:	Available Upon Request
Installation:	Installed Over A Solid Substrate (Vertical or Horizontal)

*Limited warranty. Please review prior to purchase.

TESTING AND APPROVALS:

- Florida Building Code - Residential (FBC)
- ASTM E330 – Uniform Load Structural Test (wall)
- AASTM A653 – G90 Galvanized
- ASTM A792 – Zincalume/Galvalume AZ-50/55

For the complete list, please contact your sales representative

APPLIES TO THE FOLLOWING COLORS/FINISHES:

- | | | |
|-------------------|------------------|-------------------|
| • Almond | • Dark Bronze | • Regal Red |
| • Ash Gray | • Desert Tan | • Regal White |
| • Bone White | • Dolphin Gray | • Royal Blue |
| • Burnished Slate | • Dove Gray | • Sandstone |
| • Champagne† | • Gun Metal Gray | • Silver Metallic |
| • Charcoal Gray | • Mansard Brown | • Slate Blue |
| • Classic Green | • Matte Black | • Slate Gray |
| • Colonial Red | • Medium Bronze | • Terra Cotta |
| • Copper Penny† | • Regal Blue | • Zinc Metallic |

† This material is batch sensitive and directional.
Do not mix batches or coil lots.

PROFILE:

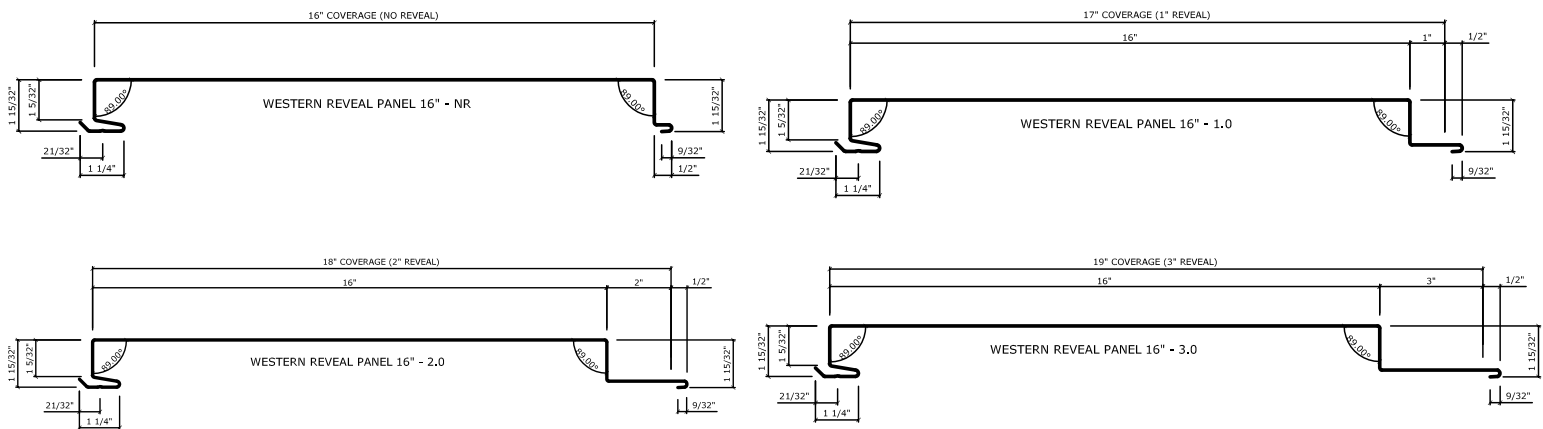

Colors represented on this profile sheet may not match actual material. All colors should be verified using an actual metal color sample.

4131-22 Rev. 01.14.25

Phoenix: ☎ (602) 495-0048 ✉ sales@westernstatesmetalroofing.com | Washington: ☎ (509) 418-2833 ✉ washington-wsmr@westernstatesmetalroofing.com

Tucson: ☎ (520) 574-4247 ✉ tucsonsales@westernstatesmetalroofing.com | Texas: ☎ (972) 843-4343 ✉ texas-sales@westernstatesmetalroofing.com



Finishes You've Never Seen Before®

WESTERN REVEAL® FLUSH REVEAL PANEL - 18" FACE SIZE

For Metal Wall Panels, Fascia, Soffit, and Ceiling Panels

Available Materials: Aluminum, Copper, Corten/A606-4, Steel

Available Finishes: Bare Steel, Galvalume®/Zincalume®, Galvanized, PVDF, SMP Painted

METAL WALL PANELS



View Product

SPECIFICATIONS:

Profile Type:	Western Reveal®
Face Size:	18"
Available Reveals:	<ul style="list-style-type: none"> • NR - No Reveal • 1.0 - 1" Reveal • 2.0 - 2" Reveal • 3.0 - 3" Reveal
Available Gauges:	24, 22
Fastening Type:	Concealed
Rib Height:	1.5"
Panel Length:	1' to 35' max
Substrate:	AZ 50 Minimum (Galvalume®/Zincalume®)
Finish:	Cool Tech® 500 – PVDF
Warranty:	40 year limited*
Stiffening Ribs or Pencil Ribs:	Available Upon Request
Single or Double Vent Strips:	Available Upon Request
Installation:	Installed Over A Solid Substrate (Vertical or Horizontal)

TESTING AND APPROVALS:

- Florida Building Code - Residential (FBC)
- ASTM E330 – Uniform Load Structural Test (wall)
- AASTM A653 – G90 Galvanized
- ASTM A792 – Zincalume/Galvalume AZ-50/55

For the complete list, please contact your sales representative

APPLIES TO THE FOLLOWING COLORS/FINISHES:

- | | | |
|-------------------|------------------|--------------------|
| • Almond | • Dark Bronze | • Regal Red |
| • Ash Gray | • Desert Tan | • Regal White |
| • Bone White | • Dolphin Gray | • Royal Blue |
| • Burnished Slate | • Dove Gray | • Sandstone |
| • Champagne† | • Gun Metal Gray | • Silver Metallic† |
| • Charcoal Gray | • Mansard Brown | • Slate Blue |
| • Classic Green | • Matte Black | • Slate Gray |
| • Colonial Red | • Medium Bronze | • Terra Cotta |
| • Copper Penny† | • Regal Blue | • Zinc Metallic† |

*Limited warranty. Please review prior to purchase.

† This material is batch sensitive and directional.
Do not mix batches or coil lots.

PROFILE:

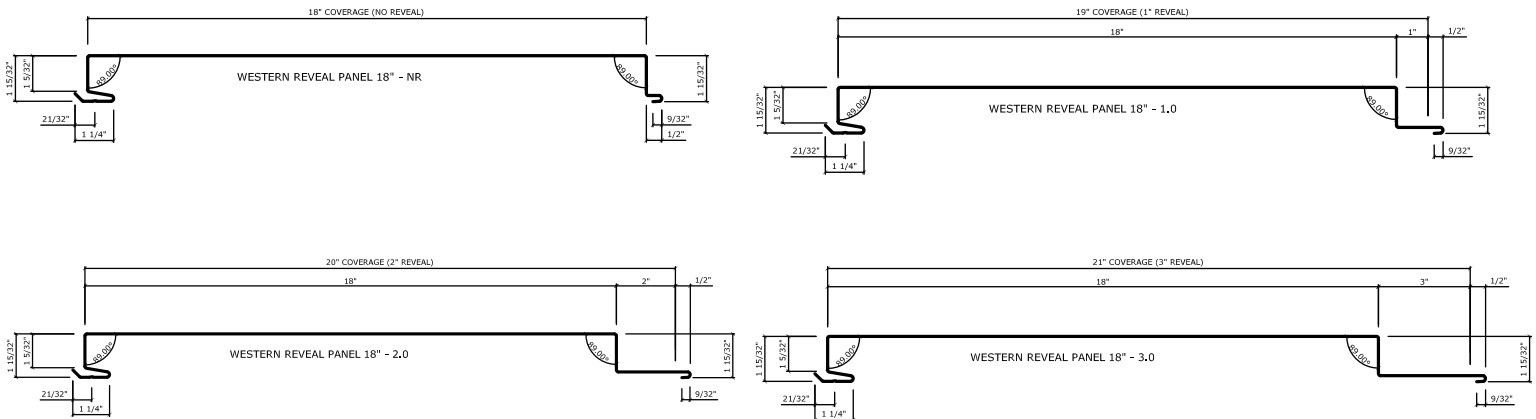

Colors represented on this profile sheet may not match actual material. All colors should be verified using an actual metal color sample.

4131-22 Rev. 01.14.25